

PRECI-FLEX[®]

The Flexible Tool System



Infracore



EXSYS

EPPINGER

EXSYS Tool, Inc. T:800.397.9748 F:800.397.9739 P:352.588.4345 www.doosantooling.com

CONTACT INFORMATION

Main Distribution • Repair and Maintenance Service • Preventative Maintenance Program

USA • MEXICO • CANADA

EXSYS Tool, Inc. &
EXSYS Tool Repair, LLC.
11654 Corporate Lake Blvd.
San Antonio, FL 33576

Toll Free: (800) 397.9748

Toll Free Fax: (800) 397.9739

Phone: (352) 588.4345

Fax: (352) 588.4821

Web: www.exsys-tool.com

Email: Info@exsys-tool.com



TABLE OF CONTENTS

BMT45CC TURRET.....1-3

Puma MX1600 (ST)

Lynx 220 (M, LM, MS)

BMT55CC TURRET.....4-6

Puma 1500 / 2000 / 2500 (M,S,Y)

Puma 2100 (Y,LY,SY,LSY)

Puma 230 / 240 / 280 (M,LM,S)

Puma GT2100M

Puma H250TM

Puma MX2100 (ST,LST)

Puma TL2000 / 2500 (M,LM)

Puma TT1500 / 1800 (MS,SY)

VTT/TL2000 / 2500 (M,S,Y)

Lynx 300 (M)

BMT65CC TURRET.....7-9

Puma 2100 / 2600 (M,LM,MS,LMS,Y,LY,SY,LSY)

Puma 300 (M,MS,MB,MC)

Puma 3100 (M,LM,LY,XLM,XLY,ULM,ULY)

Puma MX2000 / 2500

Puma MX2600 (T,ST)

Puma TT2500 (MS,SY)

Puma V400 (M)

VT450 (M,2SP)

VTT / TL 2000 / 2500 (M,S,Y)

BMT75CC TURRET.....10-11

Puma 400 / 480 (M,LM,XLM)

Puma 500 (M)

Puma V550 (M)

VT750 (M,2SP)

BMT85CC TURRET.....12-14

Puma 600 / 700 / 800 (M, LM, XLM, XLY)

VT1100M

VT900 (M, 2SP)

ACCESSORIES..... 15-18

PRECI-FLEX® INFORMATION

PRECI-FLEX® System..... 19

PRECI-FLEX® Kit..... 20

TECHNICAL INFORMATION

Adapter Change & Key Locating System 21

Compensating Clutch..... 22

NOTES.....23-24



11654 Corporate Lake Blvd.
San Antonio, Florida 33576
T: 800.397.9748
P: 352.588.4345
F: 352.588.4821

www.doosantooling.com

BMT45CC TURRET

PRECI-FLEX®

Puma

MX1600 (ST)

Lynx

220 (M,LM,MS)

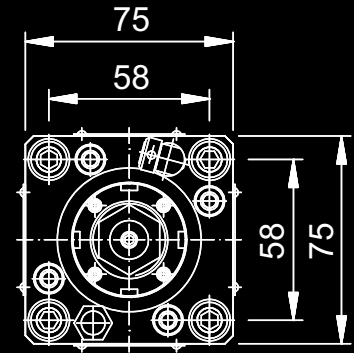
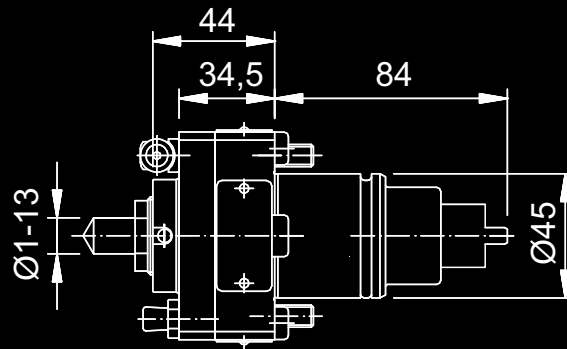

Part no..... **7.073.120** (Ext. Coolant)
(previously 7.072.585)

Part no..... **7.073.358** (Int. Coolant)
(previously 7.072.590)

Ratio..... **i=1:1**
Input RPM..... **max. 6000 1/min**
Output RPM..... **max. 6000 1/min**
Output Torque..... **max. 25 Nm**
Direction of Rotation..... **Input=Output:Yes**
Collet Size..... **ER20**

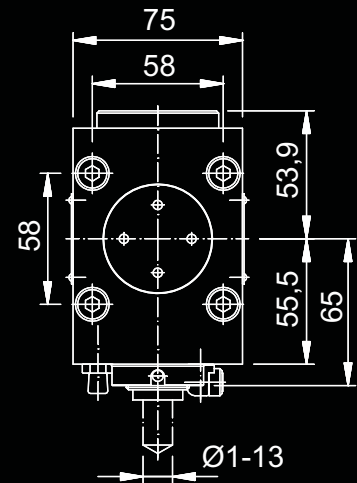
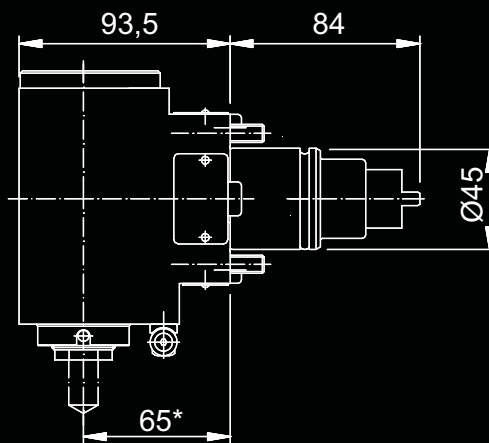

Part no..... **7.073.267** (Ext. Coolant)
(previously 7.072.587)

Part no..... **7.073.359** (Int. Coolant)
(previously 7.072.588)

Ratio..... **i=1:1**
Input RPM..... **max. 6000 1/min**
Output RPM..... **max. 6000 1/min**
Output Torque..... **max. 25 Nm**
Direction of Rotation..... **Input=Output:Yes**
Collet Size..... **ER20**

Puma

MX1600 (ST)

Lynx

220 (M,LM,MS)

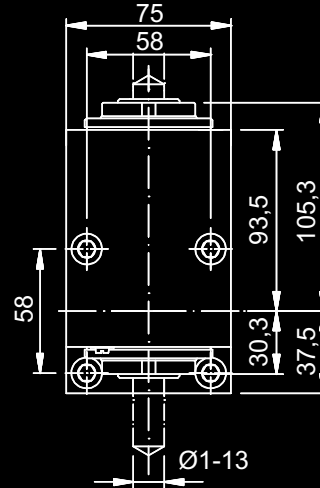
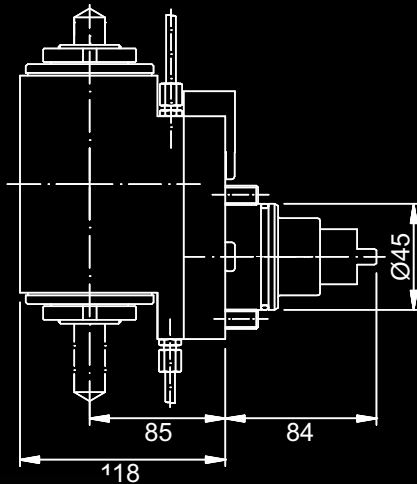

Part no..... 7.075.684 (Ext. Coolant)
 Ratio..... i=1:1
 Input RPM..... max. 6000 1/min
 Output RPM..... max. 6000 1/min
 Output Torque..... max. 40 Nm
 Direction of Rotation..... Input=Output:Yes
 Collet Size..... ER20

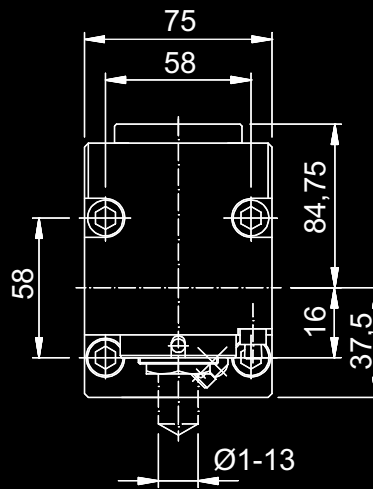
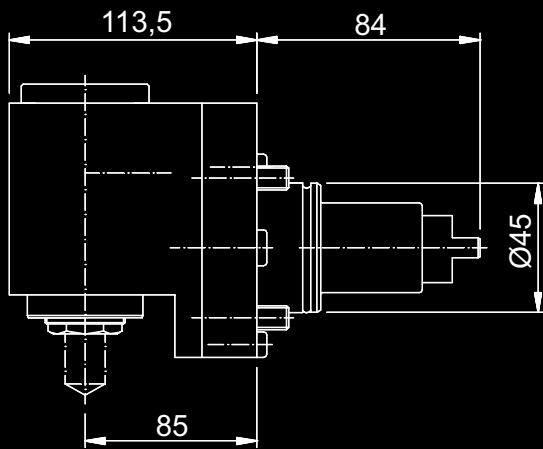

Part no..... 7.075.005 (Ext. Coolant)
 Part no..... 7.075.875 (Int. Coolant)
 Ratio..... i=1:1
 Input RPM..... max. 6000 1/min
 Output RPM..... max. 6000 1/min
 Output Torque..... max. 25 Nm
 Direction of Rotation..... Input=Output:Yes
 Collet Size..... ER20

Puma

MX1600 (ST)

Lynx



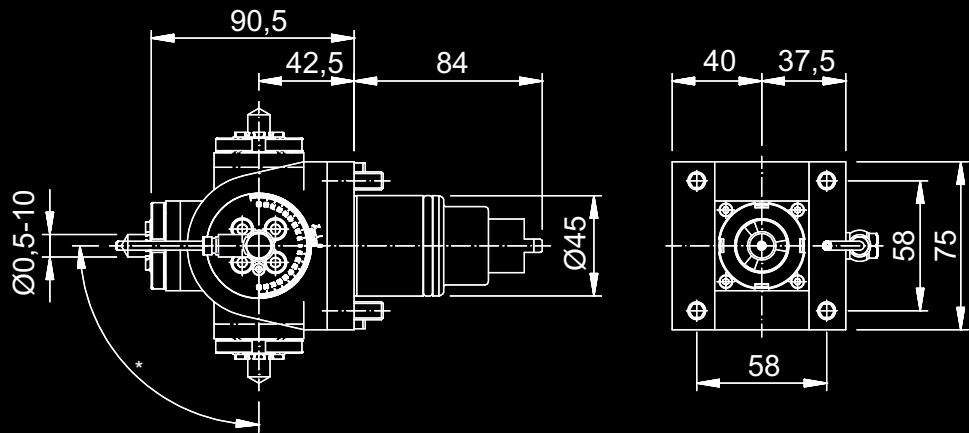



220 (M,LM,MS)

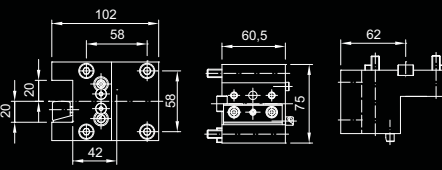

Part no..... **7.073.606** (Ext. Coolant)
(previously 7.073.220)

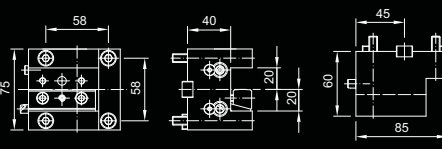
Ratio..... **i=1:1**
 Input RPM..... **max. 6000 1/min**
 Output RPM..... **max. 6000 1/min**
 Output Torque..... **max. 8 Nm**
 Direction of Rotation..... **Input=Output:No**
 Collet Size..... **ER16**

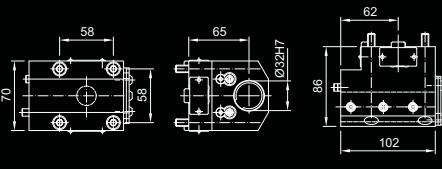
* **WARNING:** maximum tool extension at specific angles may be limited by the flight circle of your machine.

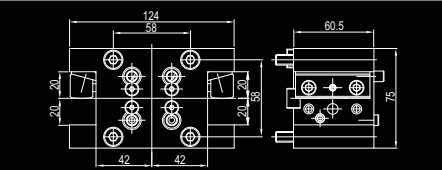
Static Tool Holders		Description	Part No.
		<ul style="list-style-type: none"> Type I Axial OD Tool Holder Axial left hand offset rectangular transverse External coolant supply 	7.074.610 (mm) Available in 3/4"
		<ul style="list-style-type: none"> Type II Axial OD Tool Holder Radial left hand / right hand rectangular transverse External coolant supply 	7.074.616 (mm) Available in 3/4"
		<ul style="list-style-type: none"> Single ID Boring Bar Holder Radial left hand / right hand cylindrical chuck External and Internal coolant supply 	7.074.255 (mm) Available in 1 1/4"
		<ul style="list-style-type: none"> Double OD Tool Holder Axial, multiple rectangular transverse External coolant supply 	7.075.572 (mm) Available in 3/4"

Puma

1500 / 2000 / 2500 (M,S,Y)
 2100 (Y,LY,SY,LSY)
 230 / 240 / 280 (M,LM,S)
 GT2100M
 H2500TM
 MX2100 (ST,LST)
 TL2000 / 2500 (M,LM)
 TT1500 / 1800 (MS/SY)
 VTT/TL2000/2500 (M,S,Y)

Lynx

300 (M)

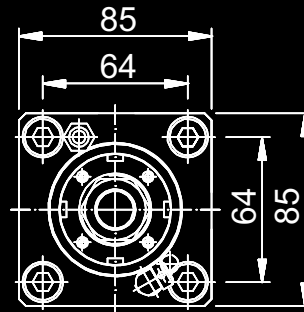
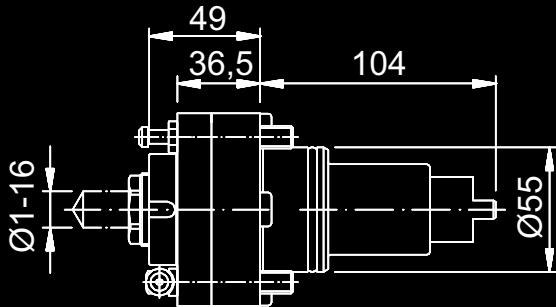

Part no..... **7.073.118** (Ext. Coolant)
(previously 7.071.703)
 Part no..... **7.073.360** (Int. Coolant)
(previously 7.071.880)
 Ratio..... **i=1:1**
 Input RPM..... **max. 6000 1/min**
 Output RPM..... **max. 6000 1/min**
 Output Torque..... **max. 40 Nm**
 Direction of Rotation..... **Input=Output:Yes**
 Collet Size..... **ER25**

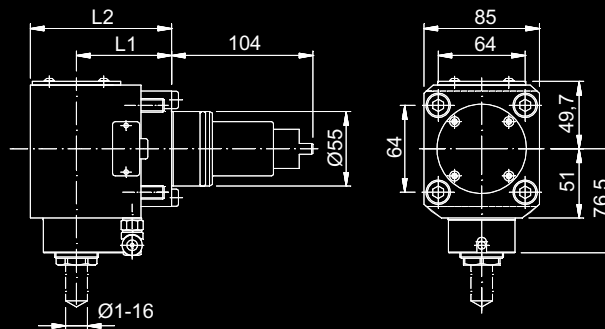

Part no...TT1500SY / TT1800SY... **7.073.280** (Ext. Coolant)
(previously 7.072.310)
 Part no...TT1500SY / TT1800SY... **7.073.362** (Int. Coolant)
(previously 7.072.544)
 Part no.....All Other BMT55..... **7.073.270** (Ext. Coolant)
(previously 7.071.940)
 Part no.....All Other BMT55..... **7.073.361** (Int. Coolant)
(previously 7.071.970)

	L2	L1
Part no...TT1500SY / TT1800SY... 7.073.280 (Ext. Coolant) <small>(previously 7.072.310)</small>	119mm	85mm
Part no...TT1500SY / TT1800SY... 7.073.362 (Int. Coolant) <small>(previously 7.072.544)</small>	119mm	85mm
Part no.....All Other BMT55..... 7.073.270 (Ext. Coolant) <small>(previously 7.071.940)</small>	104mm	70mm
Part no.....All Other BMT55..... 7.073.361 (Int. Coolant) <small>(previously 7.071.970)</small>	104mm	70mm

Ratio..... **i=1:1**
 Input RPM..... **max. 6000 1/min**
 Output RPM..... **max. 6000 1/min**
 Output Torque..... **max. 40 Nm**
 Direction of Rotation..... **Input=Output:Yes**
 Collet Size..... **ER25**

BMT55CC TURRET

PRECI-FLEX®

Puma

1500 / 2000 / 2500 (M,S,Y)
 2100 (Y,LY,SY,LSY)
 230 / 240 / 280 (M,LM,S)
 GT2100M
 H2500TM
 MX2100 (ST,LST)
 TL2000 / 2500 (M,LM)
 TT1500 / 1800 (MS/SY)
 VTT/TL2000/2500 (M,S,Y)

Lynx

300 (M)

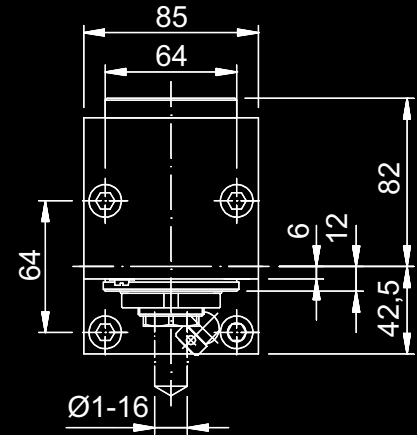
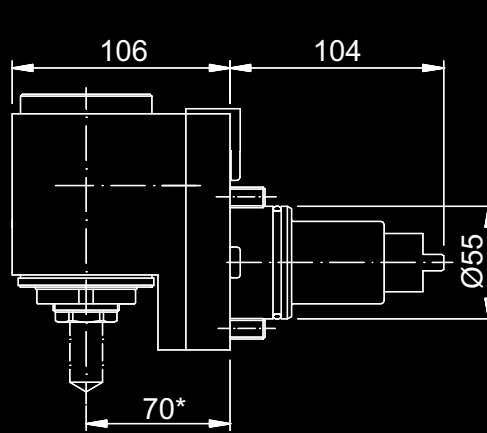

Part no..... **7.073.281** (Ext. Coolant)
 (previously 7.071.740)

Part no..... **7.073.363** (Int. Coolant)
 (previously 7.071.750)

Ratio..... **i=1:1**
 Input RPM..... **max. 6000 1/min**
 Output RPM..... **max. 6000 1/min**
 Output Torque..... **max. 40 Nm**
 Direction of Rotation..... **Input=Output: Yes**
 Collet Size..... **ER25**

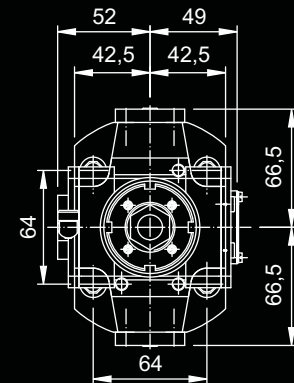
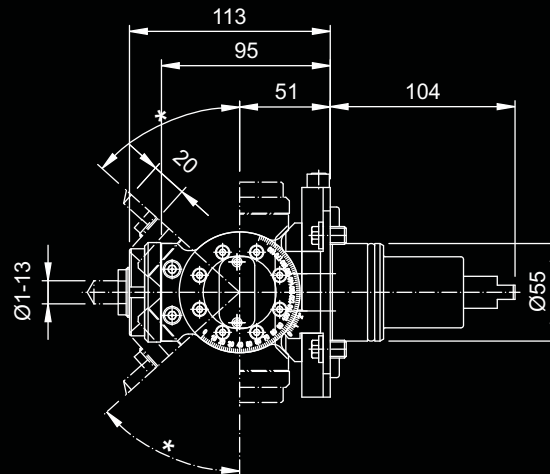

Part no..... **7.073.607** (Ext. Coolant)
 (previously 7.072.645)

Ratio..... **i=1:1**
 Input RPM..... **max. 6000 1/min**
 Output RPM..... **max. 6000 1/min**
 Output Torque..... **max. 13 Nm**
 Direction of Rotation..... **Input=Output: No**
 Collet Size..... **ER20**

* **WARNING:** maximum tool extension at specific angles may be limited by the flight circle of your machine.

Puma

- 1500 / 2000 / 2500 (M,S,Y)
- 2100 (Y,LY,SY,LSY)
- 230 / 240 / 280 (M,LM,S)
- GT2100M
- H2500TM
- MX2100 (ST,LST)
- TL2000 / 2500 (M,LM)
- TT1500 / 1800 (MS/SY)
- VTT/TL2000/2500 (M,S,Y)

Lynx



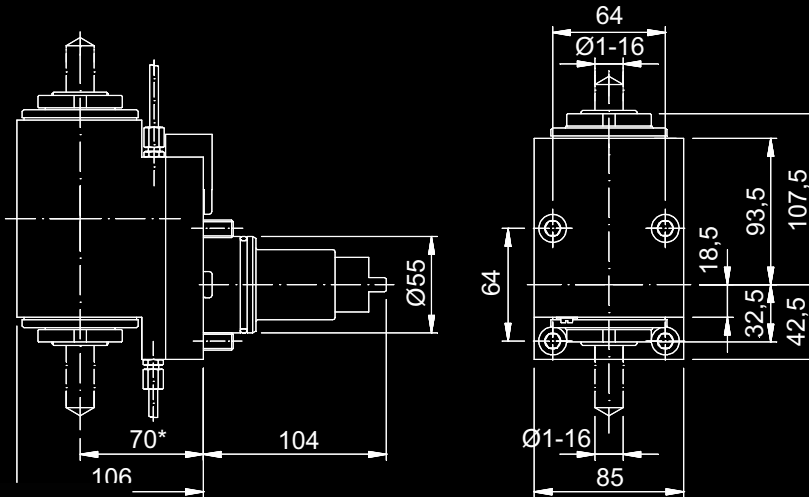





- 300 (M)

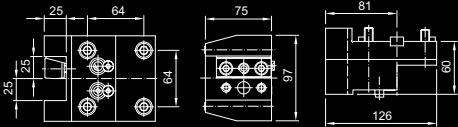

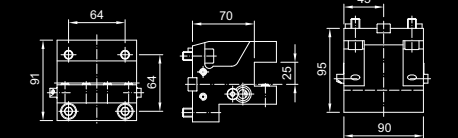
Part no..... **7.073.611** (Ext. Coolant)
(previously 7.072.480)

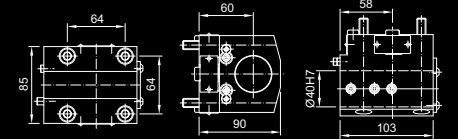
Ratio..... **i=1:1**
 Input RPM..... **max. 6000 1/min**
 Output RPM..... **max. 6000 1/min**
 Output Torque..... **max. 25 Nm**
 Collet Size..... **ER25**

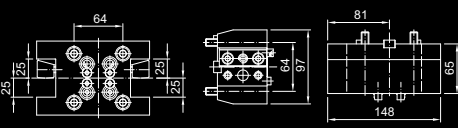
* **WARNING:** maximum tool extension at specific angles may be limited by the flight circle of your machine.

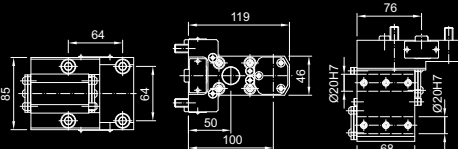
Static Tool Holders	Description	Part No.
 	<ul style="list-style-type: none"> • Type I Axial • OD Tool Holder • Axial left hand offset rectangular transverse • External coolant supply 	7.073.995 (mm) Available in 1"
 	<ul style="list-style-type: none"> • Type II Axial • OD Tool Holder • Radial left hand / right hand rectangular transverse • External coolant supply 	7.074.003 (mm) Available in 1"
 	<ul style="list-style-type: none"> • Single ID Boring Bar Holder • Radial left hand / right hand cylindrical chuck • External and Internal coolant supply 	7.074.000 (mm) Available in 1 1/2" 7.074.067 (mm) Available in 1 1/2"
 	<ul style="list-style-type: none"> • Double OD Tool Holder • Axial, multiple rectangular transverse • External coolant supply 	7.074.001 (mm) Available in 1" Double
 	<ul style="list-style-type: none"> • Double Boring Bar Holder • Radial left hand - right hand multiple cylindrical chuck • External and Internal coolant supply 	7.074.054 (mm) Available in 3/4"

BMT65CC TURRET

PRECI-FLEX®

Puma

2100 / 2600 (M,LM,MS,LMS,
Y,LY,SY,LSY)

300 (M,MS,MB,MC)

3100 (M,LM,LY,XLM,
XLY,ULM,ULY)

MX2000 / 2500

MX2600 (T,ST)

TT2500 (MS,SY)

V400 (M)

VT450 (M,2SP)

VTT/TL2000/2500 (M,S,Y)

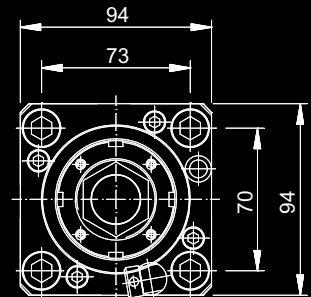
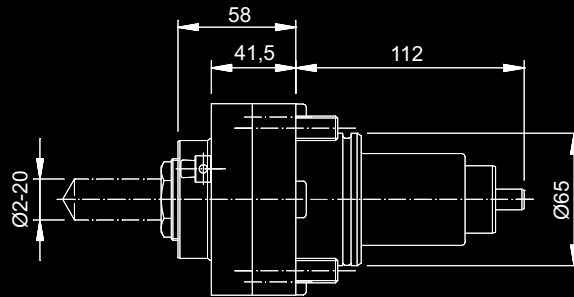

Partno..... **7.073.240** (Ext. Coolant)
(previously 7.071.753)

Partno..... **7.073.364** (Int. Coolant)
(previously 7.071.885)

Ratio..... **i=1:1**

Input RPM..... **max. 5000 1/min**

Output RPM..... **max. 5000 1/min**

Output Torque..... **max. 70 Nm**

Direction of Rotation..... **Input=Output: Yes**

Collet Size..... **ER32**

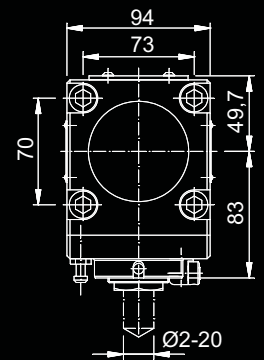
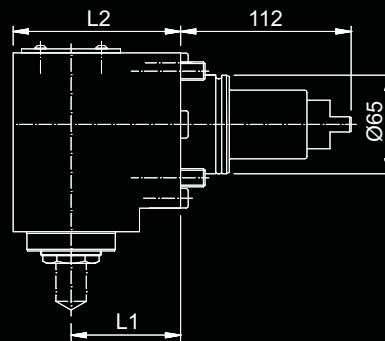

Partno.....Puma300..... **7.073.271** (Ext. Coolant)
(previously 7.071.760)

Partno.....Puma300..... **7.073.365** (Int. Coolant)
(previously 7.071.886)

Partno...AllOtherBMT65... **7.073.282** (Ext. Coolant)
(previously 7.071.975)

Partno...AllOtherBMT65... **7.073.366** (Int. Coolant)
(previously 7.071.990)

L2

L1

110mm

72mm

110mm

72mm

138mm

100mm

138mm

100mm

Ratio..... **i=1:1**

Input RPM..... **max. 5000 1/min**

Output RPM..... **max. 5000 1/min**

Output Torque..... **max. 70 Nm**

Direction of Rotation..... **Input=Output: Yes**

Collet Size..... **ER32**

Puma

- 2100 / 2600 (M,LM,MS,LMS,
Y,LY,SY,LSY)
- 300 (M,MS,MB,MC)
- 3100 (M,LM,LY,XLM,
XLY,ULM,ULY)
- MX2000 / 2500
- MX2600 (T,ST)
- TT2500 (MS,SY)
- V400 (M)
- VT450 (M,2SP)
- VTT/TL2000/2500 (M,S,Y)

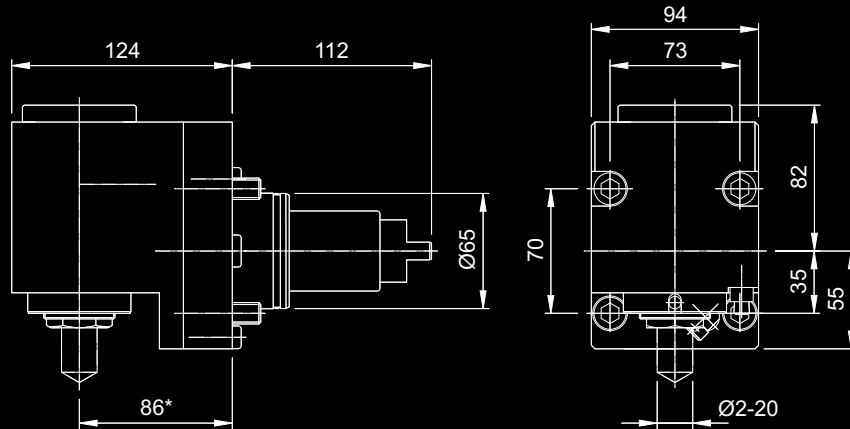

Part no..... **7.073.283** (Ext. Coolant)
(previously 7.071.761)

Part no..... **7.073.367** (Int. Coolant)
(previously 7.071.887)

Ratio..... **i=1:1**

Input RPM..... **max. 5000 1/min**

Output RPM..... **max. 5000 1/min**

Output Torque..... **max. 70 Nm**

Direction of Rotation..... **Input=Output: Yes**

Collet Size..... **ER32**

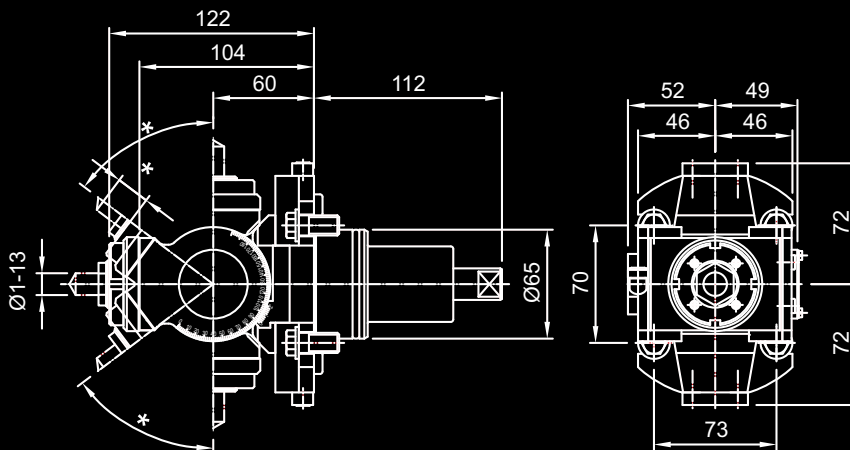

Part no..... **7.073.608** (Ext. Coolant)
(previously 7.072.305)

Ratio..... **i=1:1**

Input RPM..... **max. 5000 1/min**

Output RPM..... **max. 5000 1/min**

Output Torque..... **max. 13 Nm**

Direction of Rotation..... **Input=Output: No**

Collet Size..... **ER20**

* **WARNING:** maximum tool extension at specific angles may be limited by the flight circle of your machine.

Puma

2100 / 2600 (M,LM,MS,LMS)

2100 / 2600 (Y,LY,SY,LSY)

300 (M,MS,MB,MC)

3100 (M,LM,LY,XLM,
XLY,ULM,ULY)

MX2000 / 2500

MX2600 (T,ST)

TT2500 (MS,SY)

V400 (M)

VT450 (M,2SP)

VTT/TL2000/2500 (M,S,Y)

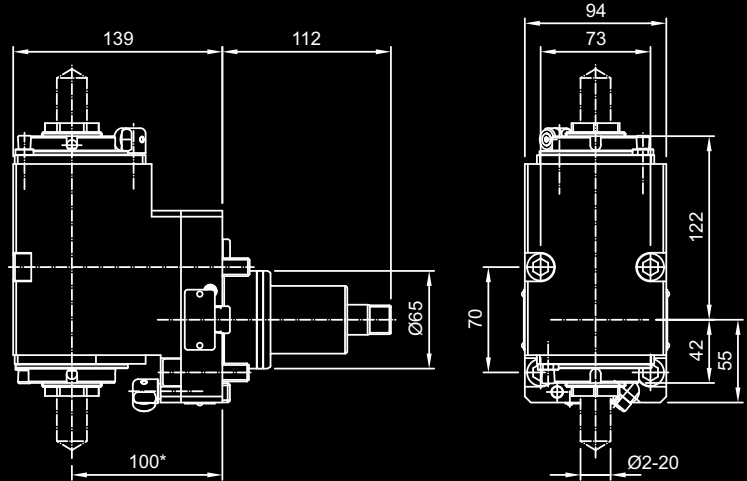

Partno..... **7.073.505** (Ext. Coolant)
(previously 7.072.645)







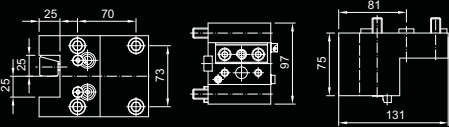

Ratio..... **i=1:1**

Input RPM..... **max. 5000 1/min**

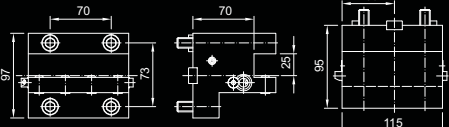
Output RPM..... **max. 5000 1/min**

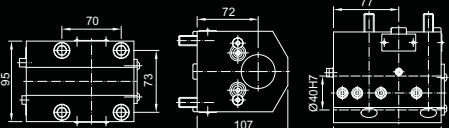
Output Torque..... **max. 70 Nm**

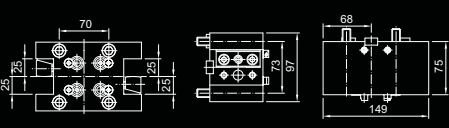
Collet Size..... **ER32**

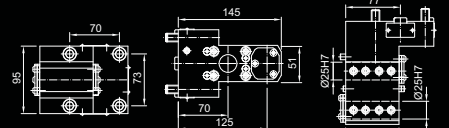
Static Tool Holders		Description	Part No.
		<ul style="list-style-type: none"> Type I Axial OD Tool Holder Axial left hand offset rectangular transverse External coolant supply 	7.074.010 (mm) Available in 1"
		<ul style="list-style-type: none"> Type II Axial OD Tool Holder Radial left hand / right hand rectangular transverse External coolant supply 	7.074.017 (mm) Available in 1"
		<ul style="list-style-type: none"> Single ID Boring Bar Holder Radial left hand / right hand cylindrical chuck External and Internal coolant supply 	7.074.030 (mm) Available in 1 1/2" 7.074.065 (mm) Available in 1 1/2"
		<ul style="list-style-type: none"> Double OD Tool Holder Axial, multiple rectangular transverse External coolant supply 	7.074.015 (mm) Available in 1"
		<ul style="list-style-type: none"> Double Boring Bar Holder Radial left hand - right hand multiple cylindrical chuck External and Internal coolant supply 	7.074.035 (mm) Available in 1" Double

Puma

400 / 480 (M,LM,XLM)

500 (M)

V550 (M,2SP)

VT750 (M,2SP)

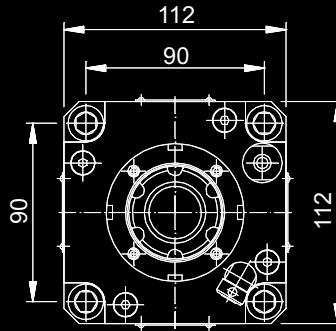
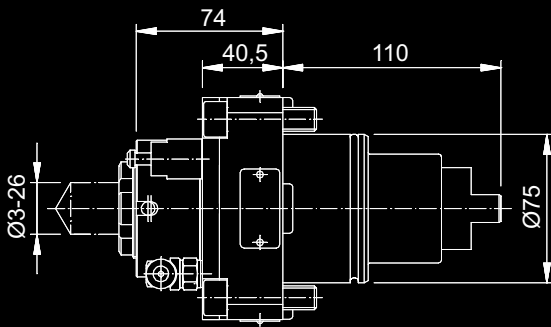

Partno..... **7.073.245** (Ext. Coolant)
(previously 7.071.810)

Partno..... **7.073.369** (Int. Coolant)
(previously 7.071.860)

Ratio..... **i=1:1**
 Input RPM..... **max. 3000 1/min**
 Output RPM..... **max. 3000 1/min**
 Output Torque..... **max. 100 Nm**
 Direction of Rotation..... **Input=Output: Yes**
 Collet Size..... **ER40**

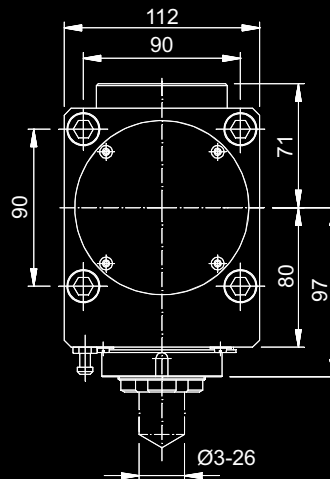
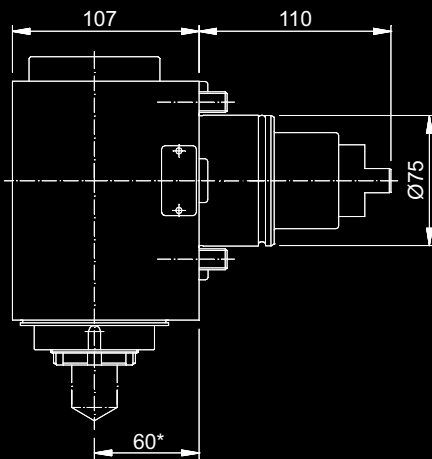

Part no..... **7.073.275** (Ext. Coolant)
(previously 7.071.835)

Part no..... **7.073.370** (Int. Coolant)
(previously 7.071.865)

Ratio..... **i=1:1**
 Input RPM..... **max. 3000 1/min**
 Output RPM..... **max. 3000 1/min**
 Output Torque..... **max. 100 Nm**
 Direction of Rotation..... **Input=Output: Yes**
 Collet Size..... **ER40**

BMT75CC TURRET

PRECI-FLEX®

Puma

400 / 480 (M,LM,XLM)

500 (M)

V550 (M,2SP)

VT750 (M,2SP)

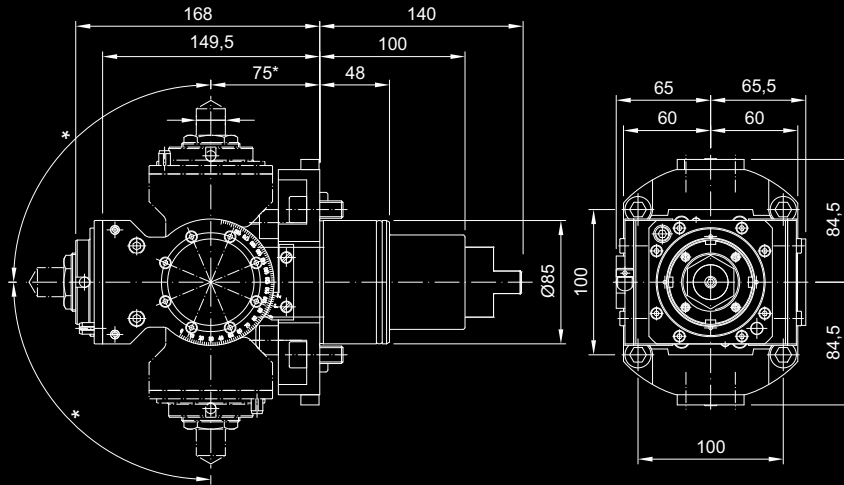

Partno..... 7.073.609 (Ext. Coolant)

Ratio..... i=1:1





Input RPM..... max. 3000 1/min

Output RPM..... max. 3000 1/min

Output Torque..... max. 25 Nm

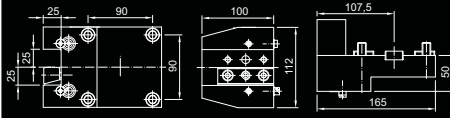
Direction of Rotation..... Input=Output: No

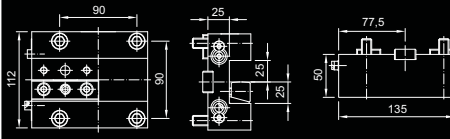
Collet Size..... ER32

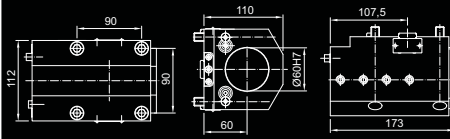
Static Tool Holders		Description	Part No.
		<ul style="list-style-type: none"> Type I Axial OD Tool Holder Axial left hand offset rectangular transverse External coolant supply 	7.074.632 (mm) Available in 1"
		<ul style="list-style-type: none"> Type II Axial OD Tool Holder Radial left hand / right hand rectangular transverse External coolant supply 	7.074.628 (mm) Available in 1"
		<ul style="list-style-type: none"> Single ID Boring Bar Holder Radial left hand / right hand cylindrical chuck External and Internal coolant supply 	7.074.637 (mm) Available in 2.5"

Puma

600 / 700 / 800
(M,LM,XLM,XLY)
VT1100M
VT900 (M,2SP)

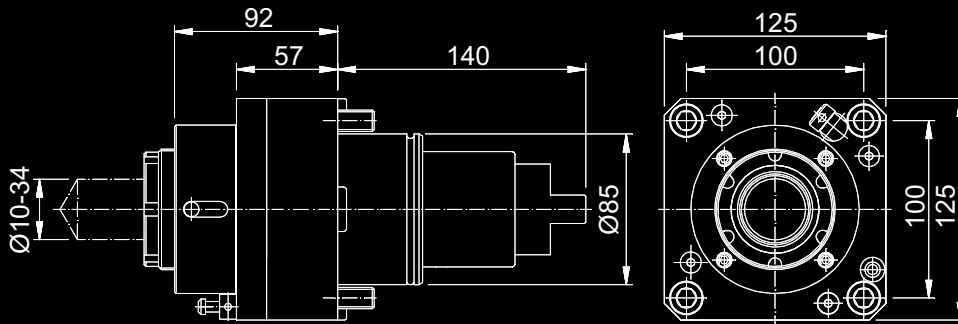

Part no..... **7.073.250** (Ext. Coolant)
(previously 7.071.840)
Part no..... **7.073.371** (Int. Coolant)
(previously 7.071.870)
Ratio..... **i=1:1**
Input RPM..... **max. 3000 1/min**
Output RPM..... **max. 3000 1/min**
Output Torque..... **max. 210 Nm**
Direction of Rotation..... **Input=Output: Yes**
Collet Size..... **ER50**

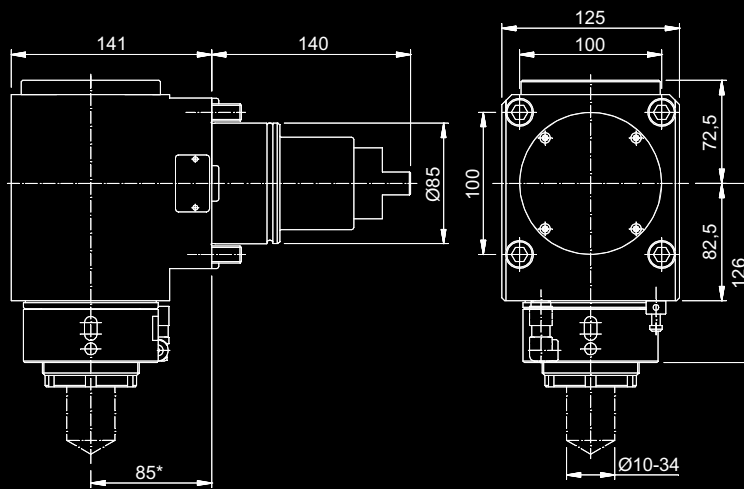

Part no..... **7.073.277** (Ext. Coolant)
(previously 7.071.845)
Part no..... **7.073.372** (Int. Coolant)
(previously 7.071.875)
Ratio..... **i=1:1**
Input RPM..... **max. 3000 1/min**
Output RPM..... **max. 3000 1/min**
Output Torque..... **max. 210 Nm**
Direction of Rotation..... **Input=Output: Yes**
Collet Size..... **ER50**

Puma

600 / 700 / 800
(M,LM,XLM,XLY)
VT1100M
VT900 (M,2SP)

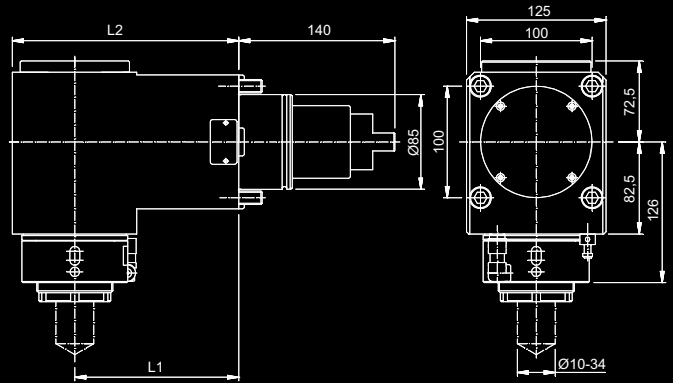
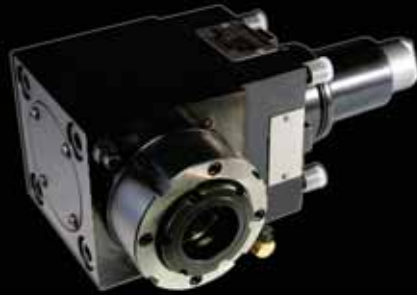

	L2	L1
Part no.....VT1100.....	7.073.330 (Ext. Coolant)	191mm 135mm
Part no.....VT1100.....	7.073.561 (Int. Coolant)	191mm 135mm
Ratio.....	i=1:1	
Input RPM.....	max. 3000 1/min	
Output RPM.....	max. 3000 1/min	
Output Torque.....	max. 210 Nm	
Direction of Rotation.....	Input=Output: Yes	
Collet Size.....	ER50	

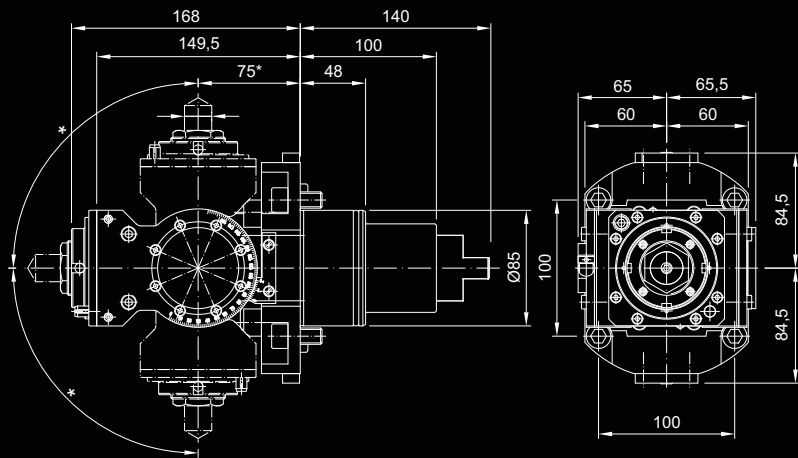

Partno.....	7.073.610 (Ext. Coolant) (previously 7.072.536)
Ratio.....	i=1:1
Input RPM.....	max. 3000 1/min
Output RPM.....	max. 3000 1/min
Output Torque.....	max. 25 Nm
Direction of Rotation.....	Input=Output: No
Collet Size.....	ER32

Puma



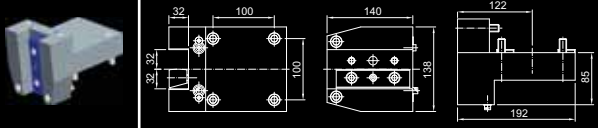
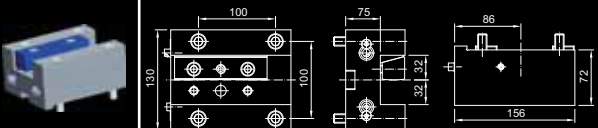
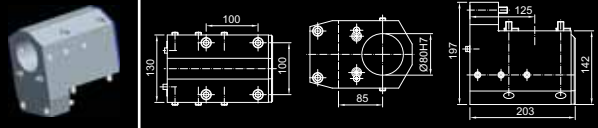

600 / 700 / 800
(M,LM,XLM,XLY)

VT1100M

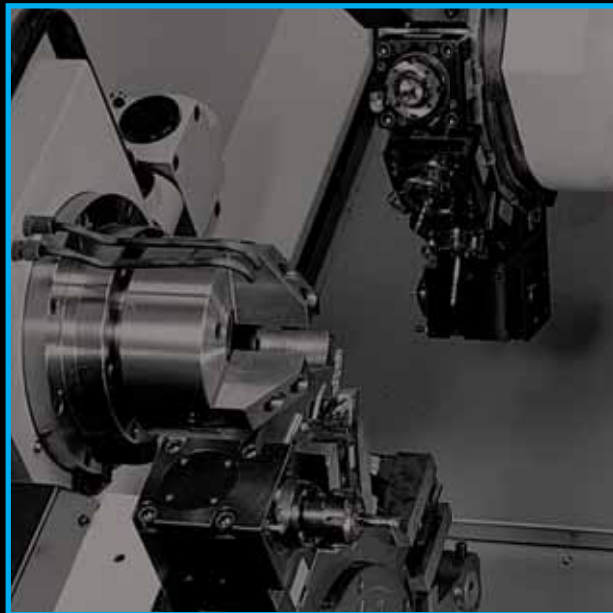
VT900 (M,2SP)

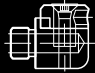
Static Tool Holders	Description	Part No.
	<ul style="list-style-type: none"> • Type I Axial • OD Tool Holder • Axial left hand offset rectangular transverse • External coolant supply 	<p>7.074.550 (mm) Available in 1"</p>
	<ul style="list-style-type: none"> • Type II Axial • OD Tool Holder • Radial left hand / right hand rectangular transverse • External coolant supply 	<p>7.074.630 (mm) Available in 1"</p>
	<ul style="list-style-type: none"> • Single ID Boring Bar Holder • Radial left hand / right hand cylindrical chuck • External and Internal coolant supply 	<p>7.074.635 (mm) Available in 2.5"</p>



	Part Number	Ext. Coolant Tube Nozzle	Collet Nut (Form F)	Collet Wrench (Form F)	Spindle Wrench	Retention Knob	PRECI-FLEX Tapered Bolts
							
BMT45CC	7.073.120 (Ext/ER20)	0.000.377	12364	SW 22	0.001.071	0.000.387	0.000.770
	7.073.358 (Int/ER20)	N/A					
	7.073.267 (Ext/ER20)	0.000.377					
	7.073.359 (Int/ER20)	N/A					
	7.073.606 (Ext/ER16)	0.000.377	3316.60000	7117.16000	10005	N/A	N/A
	7.075.005 (Ext/ER20)	0.000.377	12364	SW22	0.001.071	0.000.387	0.000.770
	7.075.875 (Int/ER20)	N/A					
	7.075.684 (Ext/ER20)	0.000.377					
BMT55CC	7.073.118 (Ext/ER25)	0.000.377	15809	SW 24	0.000.468	0.000.387	0.000.510
	7.073.360 (Int/ER25)	N/A					
	7.073.280 (Ext/ER25)	0.000.377			10006	N/A	
	7.073.362 (Int/ER25)	N/A					
	7.073.270 (Ext/ER25)	0.000.377					
	7.073.361 (Int/ER25)	N/A					
	7.073.281 (Ext/ER25)	0.000.377			0.000.468	0.000.436	
	7.073.363 (Int/ER25)	N/A					
	7.073.607 (Ext/ER20)	0.000.377	12364	10006	N/A	0.000.770	
7.073.611 (Ext/ER25)	0.000.377	15809	0.000.468	0.000.387	0.000.510		
BMT65CC	7.073.240 (Ext/ER32)	0.000.377	12946	SW 32	0.000.468	7.071.232	0.000.510
	7.073.364 (Int/ER32)	N/A					
	7.073.271 (Ext/ER32)	0.000.378				0.000.348	
	7.073.365 (Int/ER32)	N/A					
	7.073.282 (Ext/ER32)	0.000.378					
	7.073.366 (Int/ER32)	N/A					
	7.073.283 (Ext/ER32)	0.000.378				7.071.232	
	7.073.367 (Int/ER32)	N/A				0.000.976	
	7.073.368 (Ext/ER32)	0.000.378	12364	SW 22	10006	N/A	0.000.770
	7.073.608 (Ext/ER20)	0.000.378					
BMT75CC	7.073.245 (Ext/ER40)	0.000.378	15812	10006	0.000.468	0.001.317	0.000.771
	7.073.369 (Int/ER40)	N/A					
	7.073.275 (Ext/ER40)	0.000.378				0.000.348	
	7.073.370 (Int/ER40)	N/A	12946	SW32	10008	N/A	0.000.378
	7.073.609 (Ext/ER32)	0.000.378					
BMT85CC	7.073.250 (Ext/ER50)	0.000.378	15309	10008	0.000.468	0.000.353	0.000.789
	7.073.371 (Int/ER50)	N/A					
	7.073.277 (Ext/ER50)	0.000.378					
	7.073.372 (Int/ER50)	N/A					
	7.073.330 (Ext/ER50)	0.000.378	12946	SW 32	0.000.703		
	7.073.561 (Int/ER50)	N/A					
	7.073.610 (Ext/ER32)	0.000.378			10008	N/A	0.000.510

Accessories

Collet Nuts & Wrench

External Part No.	Internal Part No.						Wrench Part No.
		ER Size	Style	L1	D1	Form	
3311.60000	N/A	ER 11	ER 11 AX	7,5	M18 x 1,0	E	7117.11000
3316.60000	3316.70000	ER 16	ER 16 AX	7,6	M24 x 1,0	E	7117.16000
3320.60000	3320.70000	ER 20	ER 20 AX	8,5	M28 x 1,5	E	7117.20000
3325.60000	3325.70000	ER 25	ER 25 AX	8,8	M32 x 1,5	E	7117.25000
3332.60000	3332.70000	ER 32	ER 32 AX	9,8	M40 x 1,5	E	7117.32000
3340.60000	3340.70000	ER 40	ER 40 AX	11,7	M50 x 1,5	E	7117.40000
Ext. 12590	N/A	ER 11	ER 11 A 6 kt	8	M18 x 1,0	F	SW 13
Ext. 15806	Int. 15806	ER 16	ER 16 A 6 kt	11	M24 x 1,0	F	SW 19
Ext. 12364	Int. 12364	ER 20	ER 20 A 6 kt	12,5	M28 x 1,5	F	SW 22
Ext. 15809	Int. 15809	ER 25	ER 25 A 6 kt	14	M32 x 1,5	F	SW 24
Ext. 12946	Int. 12946	ER 32	ER 32 A 6 kt	17,7	M40 x 1,5	F	SW 32
Ext. 15812	Int. 15812	ER 40	ER 40 AC	20	M50 x 1,5	G	10006
Ext. 15309	Int. 18878	ER 50	ER 50 AK	27	M68 x 1,5	G	10008

Form E



Form F

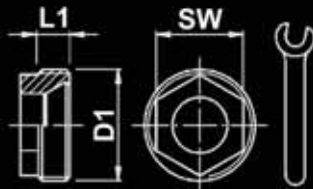

Form G

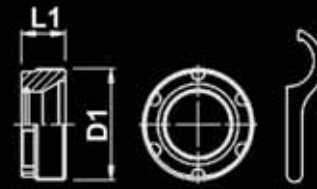

Coolant Tubes & Nozzle Unit

Part No.	Type	D1	L1	L2
0.000.377	I	M 8 x 1	8	14
0.000.378	I	M 10 x 1	8	17
218.844.220	A	M 8 x 1	60	N/A
0.000.398	G	M 8 x 1	100	N/A
218.469.220	A	M 10 x 1	90	N/A
0.000.407	G	M 10 x 1	100	N/A
218.445.220	A	M 10 x 1	100	N/A

Type: I

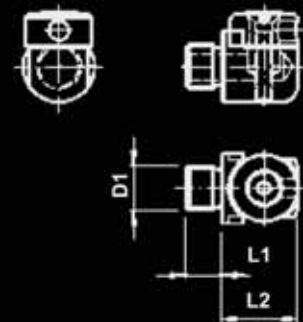

Type: A

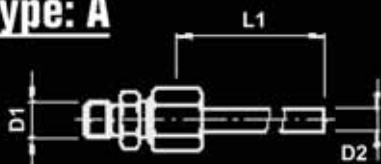

Type: G

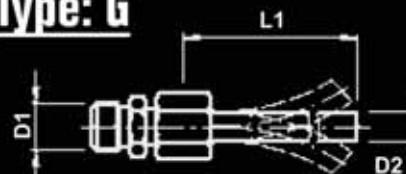



Collets

Diameter (inches)	ER16 Part No.	ER20 Part No.	ER25 Part No.	ER32 Part No.	ER40 Part No.
1/16"	1116.01592	N/A	N/A	N/A	N/A
1/8"	1116.03182	1120.03182	1125.03182	1132.03182	1140.03182
3/16"	1116.04762	1120.04762	1125.04762	1132.04762	1140.04762
1/4"	1116.06352	1120.06352	1125.06352	1132.06352	1140.06352
5/16"	1116.07942	1120.07942	1125.07942	1132.07942	1140.07942
3/8"	1116.09532	1120.09532	1125.09532	1132.09532	1140.09532
7/16"	N/A	1120.11112	1125.11112	1132.11112	1140.11112
1/2"	N/A	1120.12702	1125.12702	1132.12702	1140.12702
9/16"	N/A	N/A	1125.14292	1132.14292	1140.14292
5/8"	N/A	N/A	1125.15882	1132.15882	1140.15882
11/16"	N/A	N/A	N/A	1132.17462	1140.17462
3/4"	N/A	N/A	N/A	1132.19052	1140.19052
13/16"	N/A	N/A	N/A	1132.20642	1140.20642
7/8"	N/A	N/A	N/A	N/A	1140.22232
1"	N/A	N/A	N/A	N/A	1140.25402

Clamping Range		ER16	ER20	ER25	ER32	ER40
(mm)	(inches)	Part No.	Part No.	Part No.	Part No.	Part No.
1.0 - 0.5	0.039 - 0.019	1116.01000	1120.01000	1125.01000	N/A	N/A
2 - 1	0.079 - 0.039	1116.02000	1120.02000	1125.02000	1132.02000	N/A
3 - 2	0.118 - 0.079	1116.03000	1120.03000	1125.03000	1132.03000	1140.03000
4 - 3	0.157 - 0.118	1116.04000	1120.04000	1125.04000	1132.04000	1140.04000
5 - 4	0.197 - 0.157	1116.05000	1120.05000	1125.05000	1132.05000	1140.05000
6 - 5	0.236 - 0.197	1116.06000	1120.06000	1125.06000	1132.06000	1140.06000
7 - 6	0.276 - 0.236	1116.07000	1120.07000	1125.07000	1132.07000	1140.07000
8 - 7	0.315 - 0.276	1116.08000	1120.08000	1125.08000	1132.08000	1140.08000
9 - 8	0.354 - 0.315	1116.09000	1120.09000	1125.09000	1132.09000	1140.09000
10 - 9	0.394 - 0.354	1116.10000	1120.10000	1125.10000	1132.10000	1140.10000
11 - 10	0.433 - 0.394	N/A	1120.11000	1125.11000	1132.11000	1140.11000
12 - 11	0.472 - 0.433	N/A	1120.12000	1125.12000	1132.12000	1140.12000
13 - 12	0.512 - 0.472	N/A	1120.13000	1125.13000	1132.13000	1140.13000
14 - 13	0.551 - 0.512	N/A	N/A	1125.14000	1132.14000	1140.14000
15 - 14	0.591 - 0.551	N/A	N/A	1125.15000	1132.15000	1140.15000
16 - 15	0.630 - 0.591	N/A	N/A	1125.16000	1132.16000	1140.16000
17 - 16	0.669 - 0.630	N/A	N/A	N/A	1132.17000	1140.17000
18 - 17	0.709 - 0.669	N/A	N/A	N/A	1132.18000	1140.18000
19 - 18	0.748 - 0.709	N/A	N/A	N/A	1132.19000	1140.19000
20 - 19	0.787 - 0.748	N/A	N/A	N/A	1132.20000	1140.20000
21 - 20	0.827 - 0.787	N/A	N/A	N/A	N/A	1140.21000
22 - 21	0.866 - 0.827	N/A	N/A	N/A	N/A	1140.22000
23 - 22	0.906 - 0.866	N/A	N/A	N/A	N/A	1140.23000
24 - 23	0.945 - 0.906	N/A	N/A	N/A	N/A	1140.24000
25 - 24	0.984 - 0.945	N/A	N/A	N/A	N/A	1140.25000
26 - 25	1.027 - 0.984	N/A	N/A	N/A	N/A	1140.26000

**Other Collet sizes are available upon request. Please contact our sales office for more information.

Accessories

Boring Bar Bushings

Part No.	A	B	C	D
EX125-037	1 - 1/4"	3/8"	1 - 7/8"	2 - 1/4"
EX125-050		1/2"		
EX125-062		5/8"		
EX125-075		3/4"		
EX125-100		1"		
EX150-037	1 - 1/2"	3/6"	2 - 3/8"	2 - 3/4"
EX150-050		1/2"		
EX150-062		5/8"		
EX150-075		3/4"		
EX150-100		1"		
EX150-125		1 - 1/4"		
EX200-050	2"	1/2"	3"	3 - 1/2"
EX200-062		5/8"		
EX200-075		3/4"		
EX200-100		1"		
EX200-125		1 - 1/4"		
EX200-150		1 - 1/2"		
EX200-175		1 - 3/4"		
EX250-075	2 - 1/2"	3/4"	2 - 3/4"	4
EX250-100		1"		
EX250-125		1 - 1/4"		
EX250-150		1 - 1/2"		

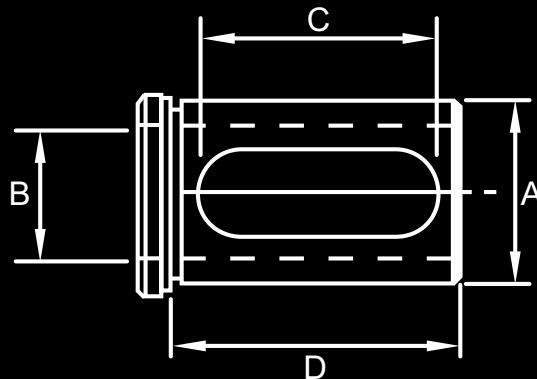

PRECI-FLEX® System

The First and Only Tooling System using a Single Base Holder for Collets and other Tooling Adapters.



- Fast
- Flexible
- Precise
- Pre-Set
- Compact
- Universal
- Economical

The **PRECI-FLEX®** interchange system makes lathe tooling change overs quick, accurate and economical.

Our highly precise repeatability is unsurpassed. Other interchangeable tooling systems cannot achieve this due to their inaccurate interfaces. Eppinger's modular system adds a new dimension to high precision flexibility. The basis of our interface is a universally utilized collet configuration. The advantages speak for themselves.

The Revolutionary Tooling System



Size	Starter Kit
ER20	0.001.001
ER25	0.001.002
ER32	0.001.003
ER40	0.001.004
ER50	0.001.005

- Please Note: All Kits Include
 - Shell Mill
 - Collet Chuck Extended
 - Weldon Shank Standard
 - Wrenches

Interchangeable PRECI-FLEX® Adapters



Standard Collet



Tapping Collet



Collet Chuck



Collet Chuck Extended



Collet Chuck Extended



Weldon Shank Standard



Weldon Shank Extended



Shell Mill



Whistle Notch



Boring Bar Holder

Adapter Change

Using the T-Wrench (1) insert and tighten the four screws (2) into the designated openings on the collet face. Then use the spanner wrench (3) to keep the spindle from rotating. This will allow a hands free approach and ensure that it is tightened properly.

NOTE :

The screw does not need to be flush when tightened.

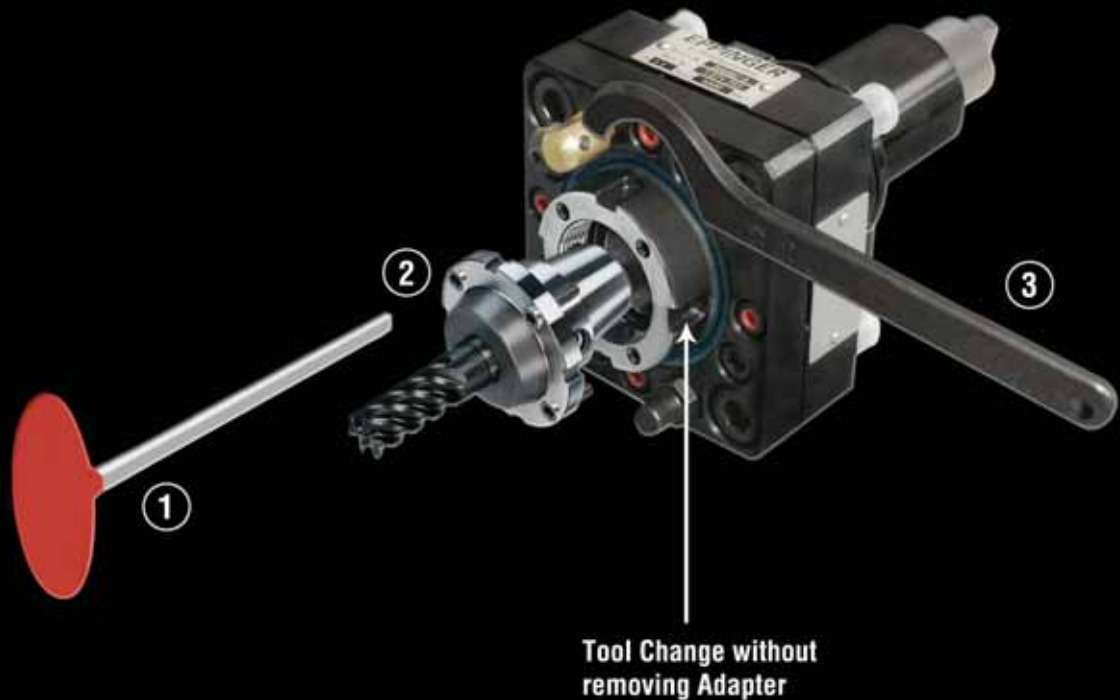

Key Locating System

The Key Locating system is an alignment system that ensures precise repeatability during tool change by centering the tool holder in the center of the turret station within microns. It was designed to save time in set-up allowing the operator to align the tool in the same position every time.

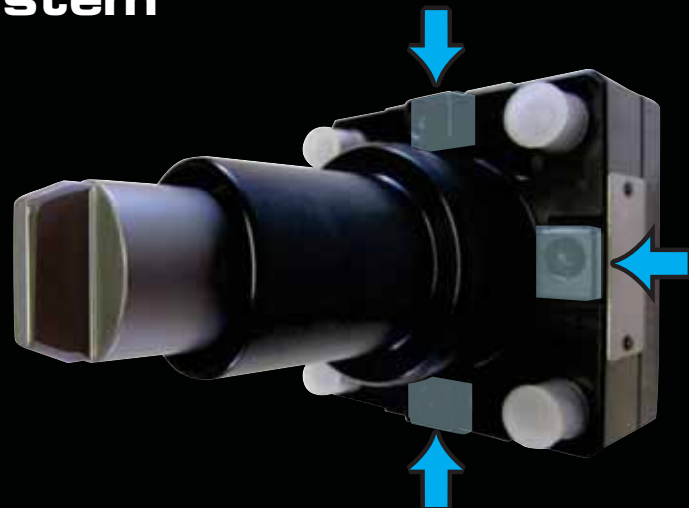

New Compensating Clutch



- The clutch is twice as big as the old coupling/clutch therefore the torque transfer is greater due to increased surface area.
- The clutch compensates for misalignment between the turret drive motor and the tool holder, therefore resulting in less wear. This is achieved by allowing the coupling of the holder to "float" in order to compensate for any misalignment.
- Better alignment with less vibrations resulting in a longer tool life, with better finishes by reducing chatter marks.



A large rectangular area with horizontal ruling lines, intended for handwritten notes. The lines are evenly spaced and cover the majority of the page's content area.

NOTES



A large rectangular area with horizontal ruling lines, intended for handwritten notes.

EXSYS **EPPINGER**

11654 Corporate Lake Blvd. San Antonio, Florida 33576
www.exsys-tool.com T:800.397.9748 P:352.588.4345 F:352.588.4821

www.doosantooling.com

